

Tavs Jorgensen

Associate Professor

Centre for Fine Print Research (CFPR)

University of the West of England

....the value of design, making and  
material (exchange)

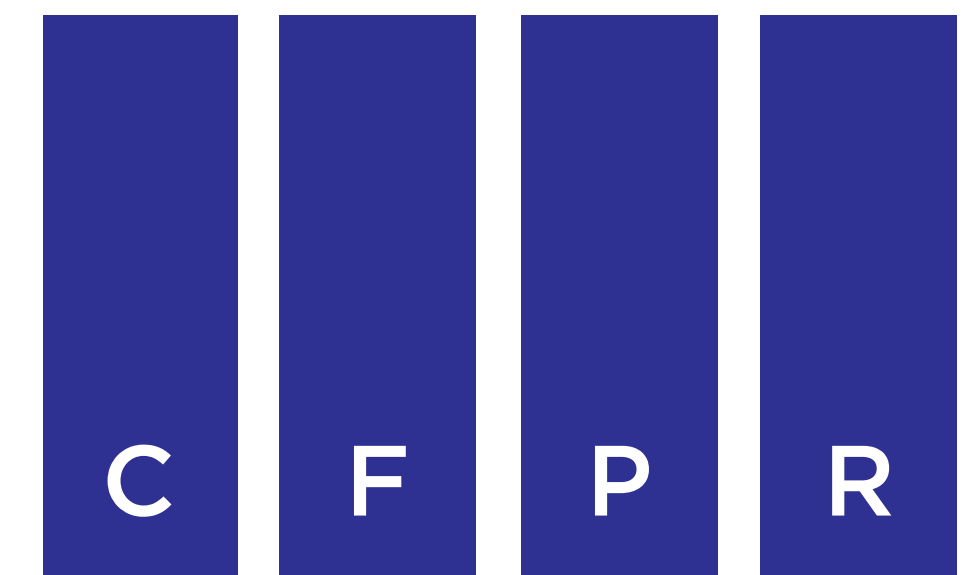
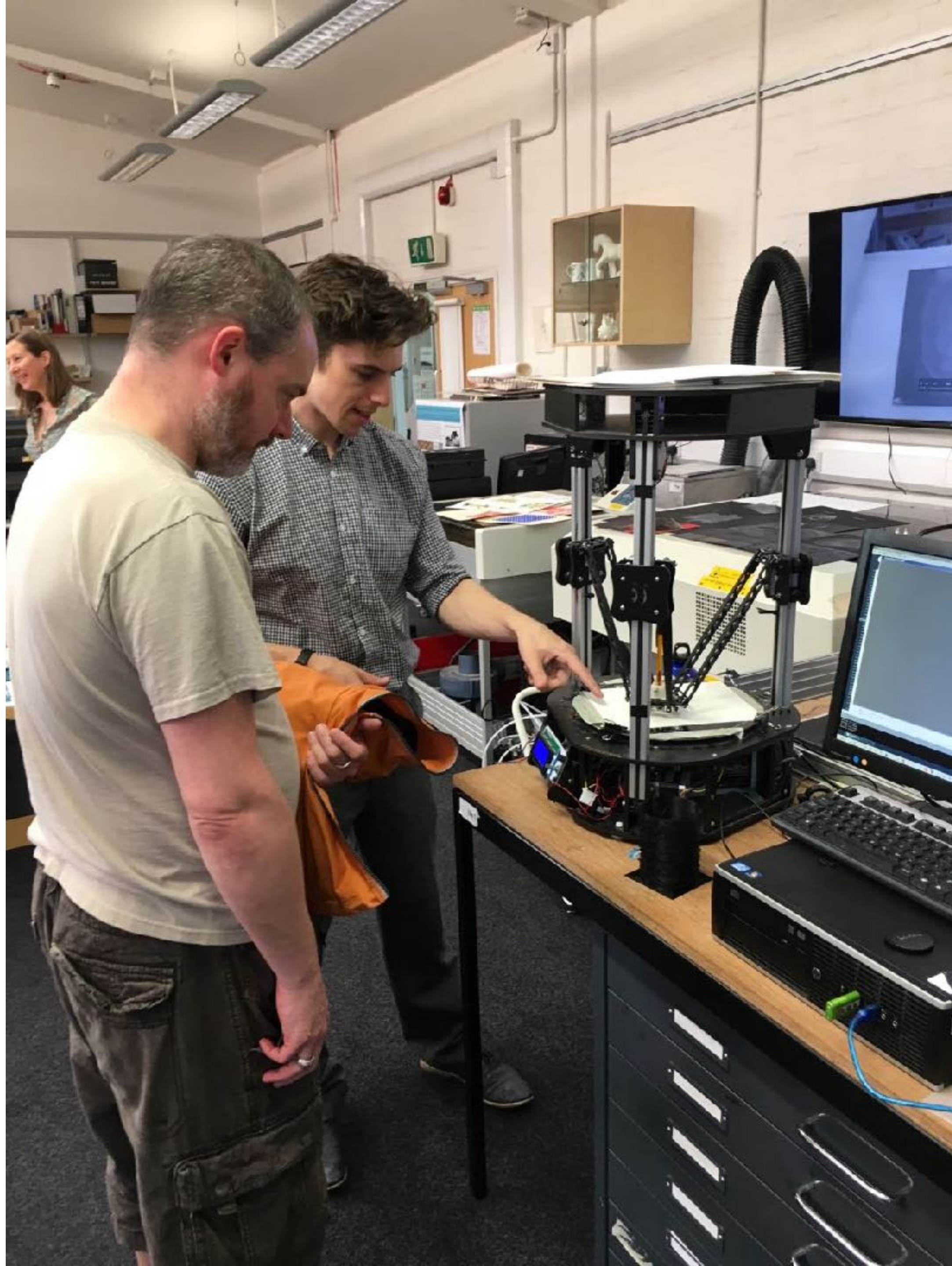

Centre for Fine Print Research

material knowledge

**ceramic extrusion**

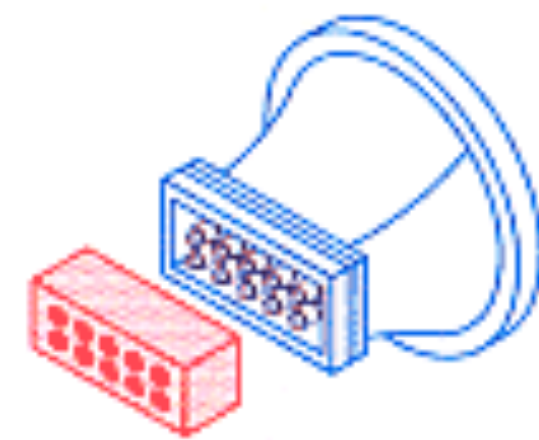

TEN HOLE CORED



STANDARD BRICK

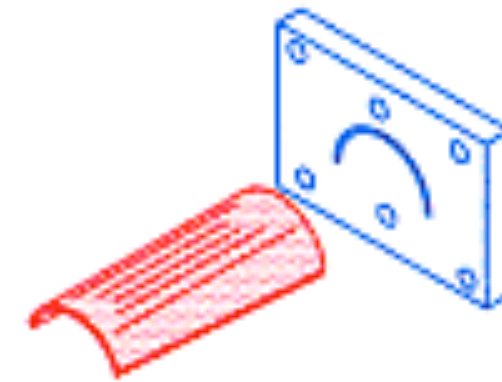

STANDARD MISSION (PCP)

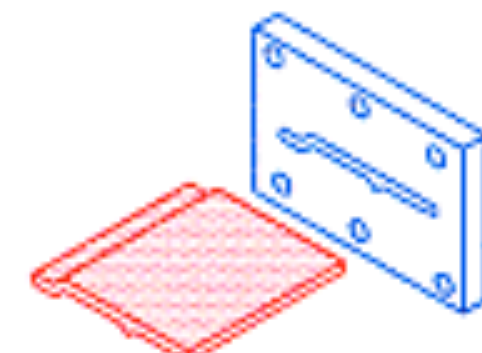

FLAT ROOF TILE

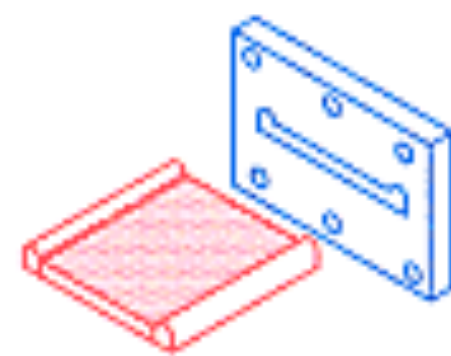

FLOOR TILE

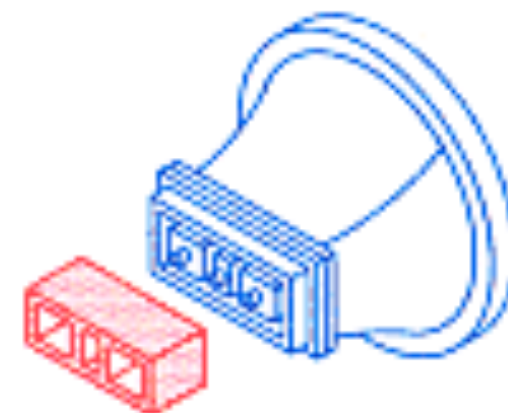

BLOCK

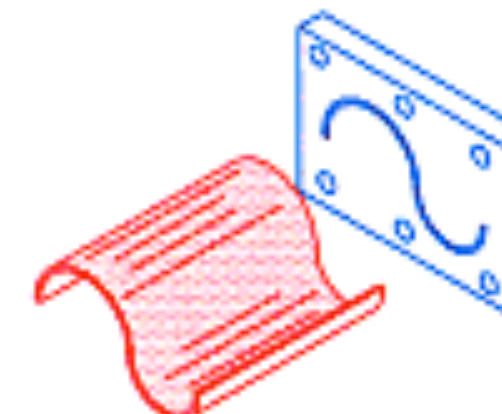

STANDARD "S" TILE

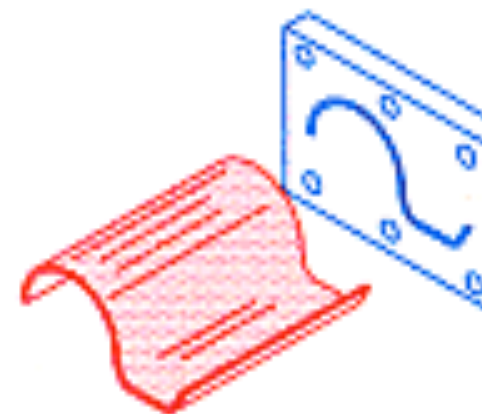

FLAT "S" TILE



Extruded tableware for Royal Crescent Hotel, Bath

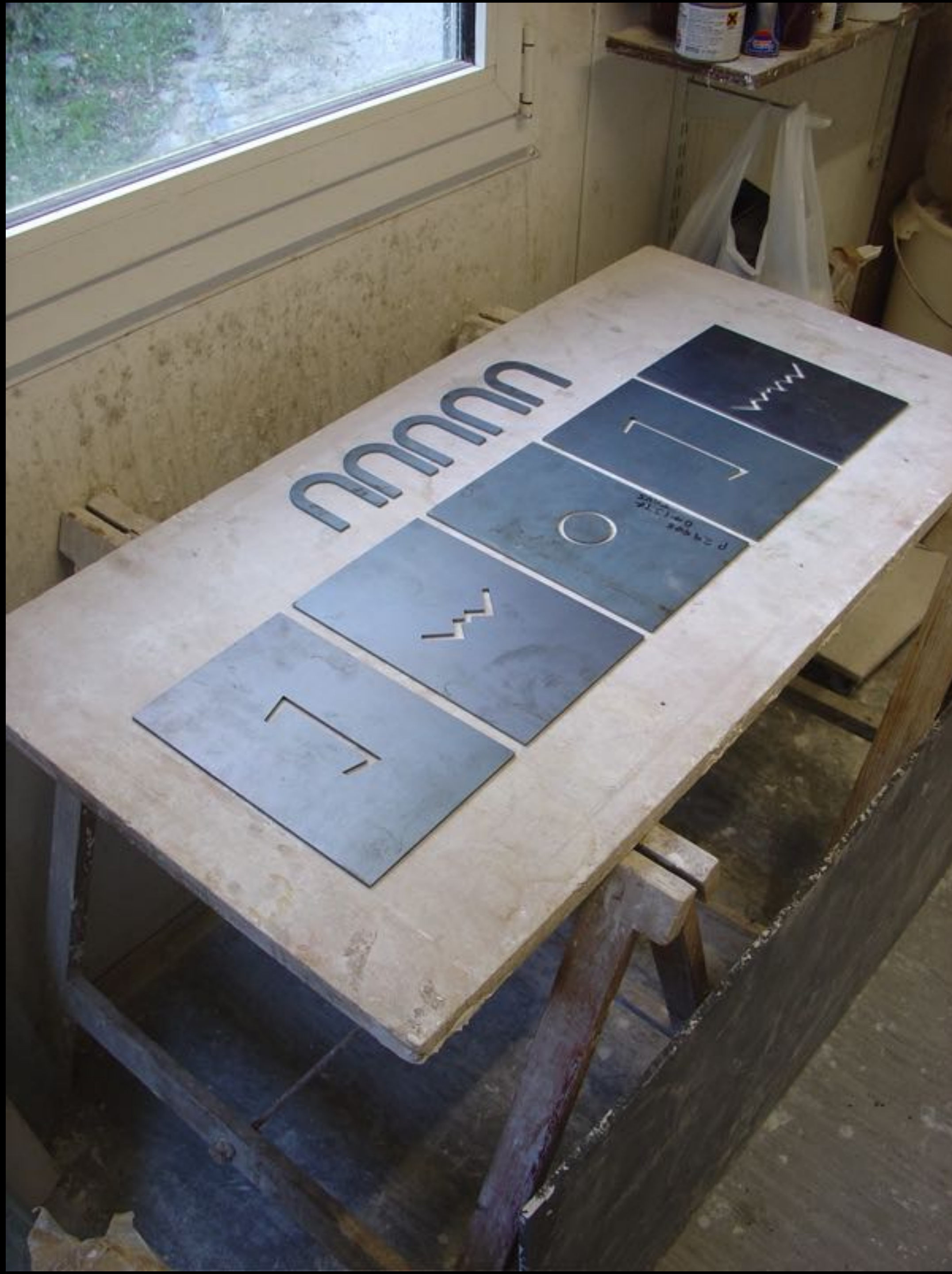



The REPRAP - open source Rapid Prototyping Project  
Andrian Bowyer, University of Bath 2006

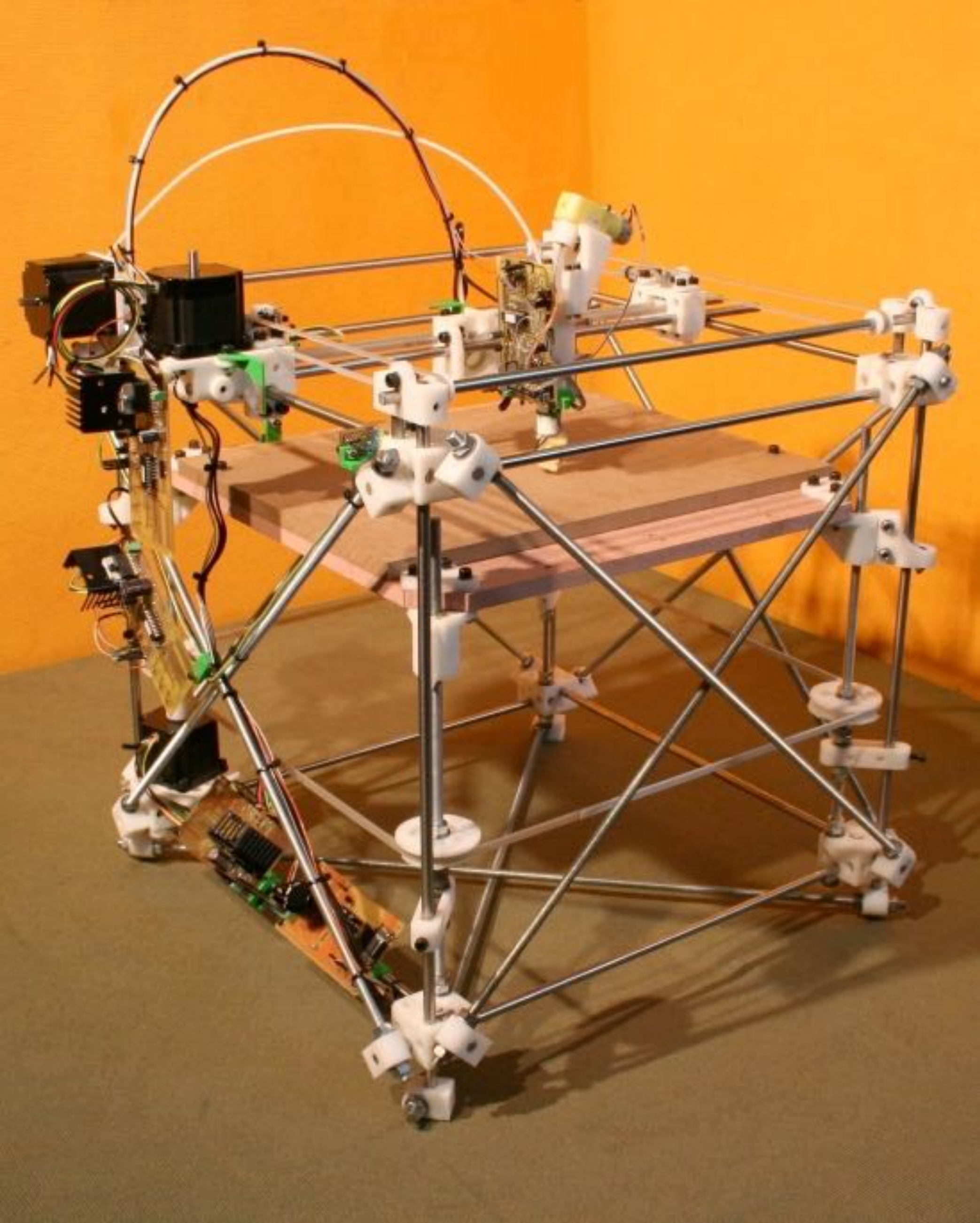

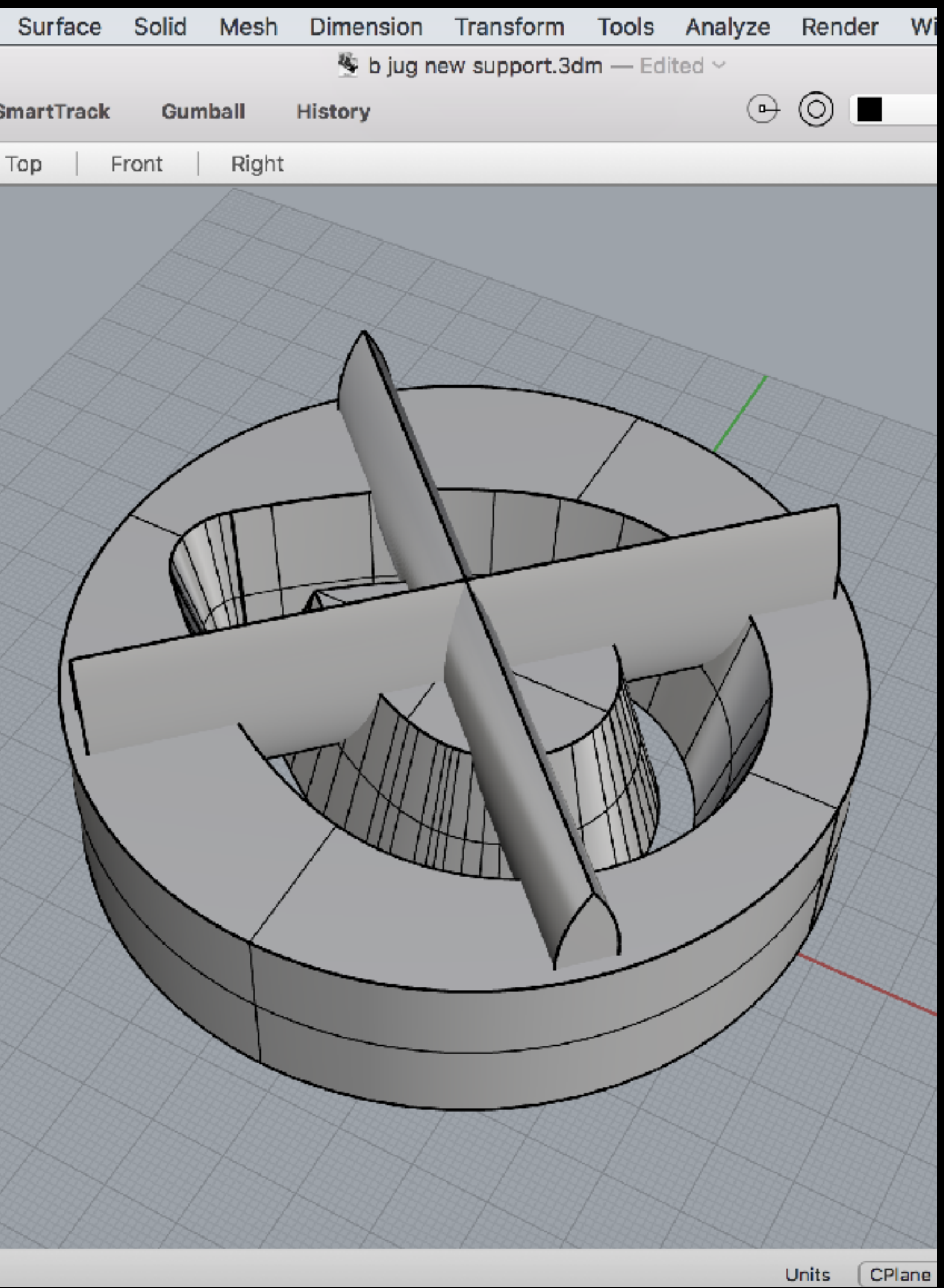





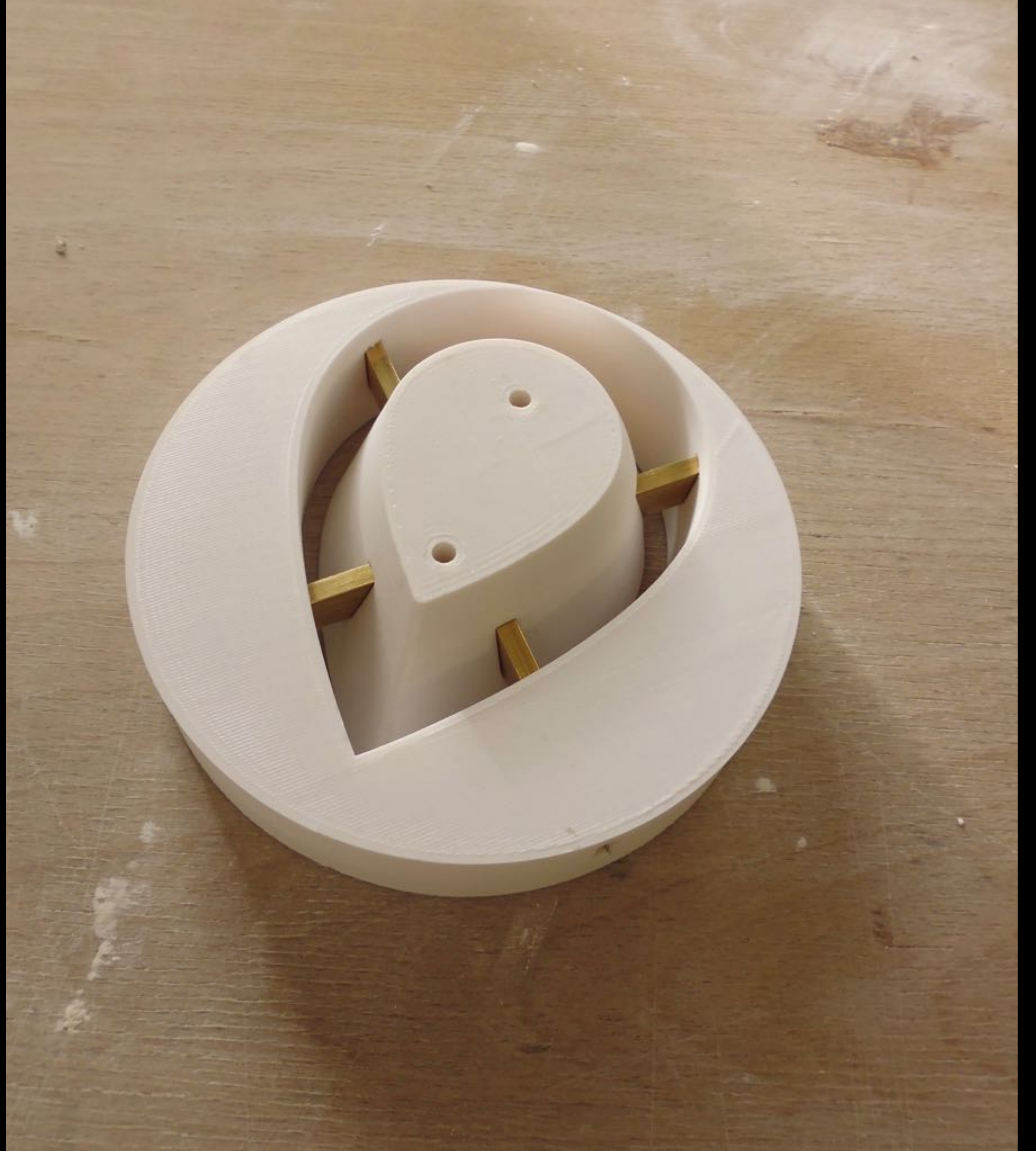
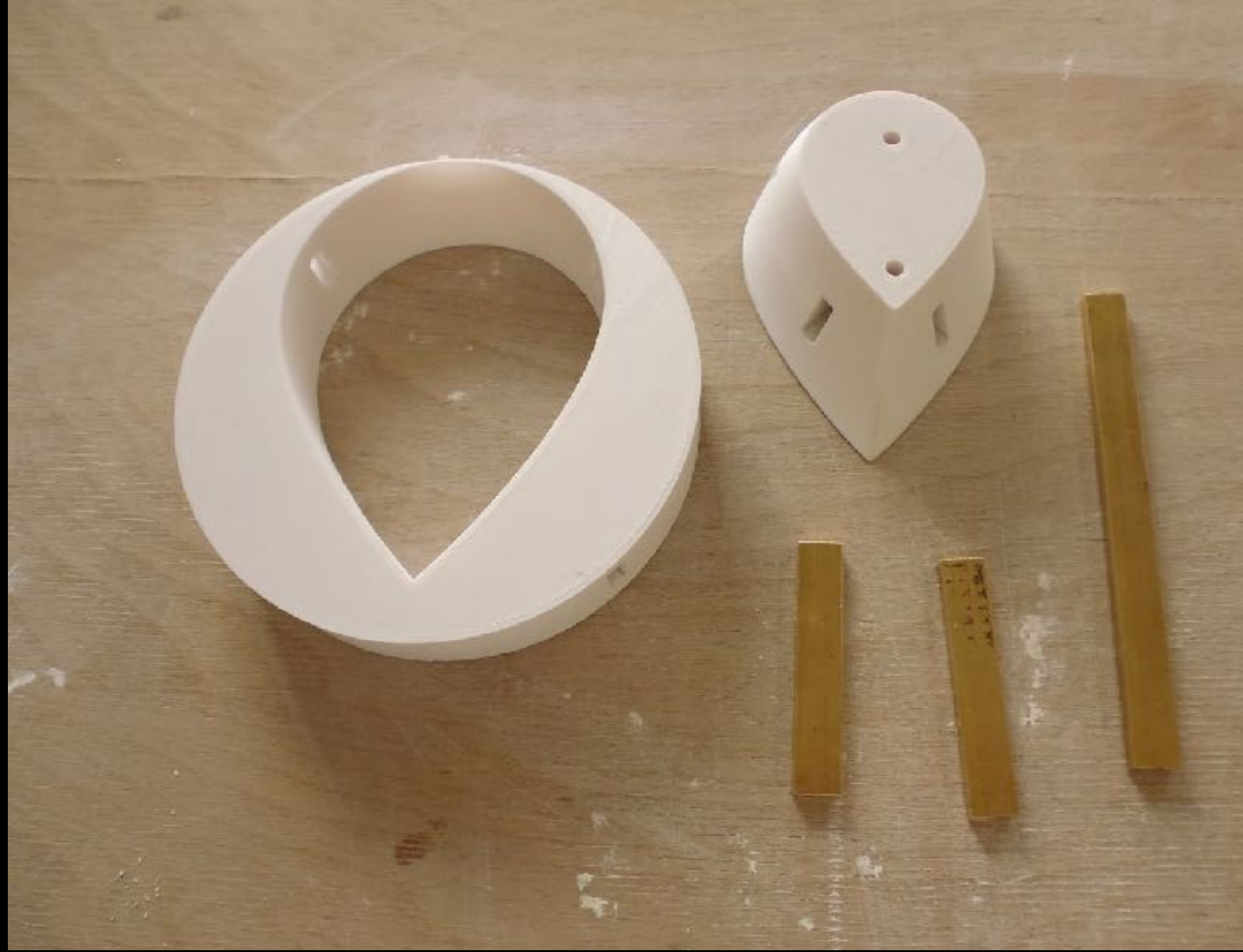

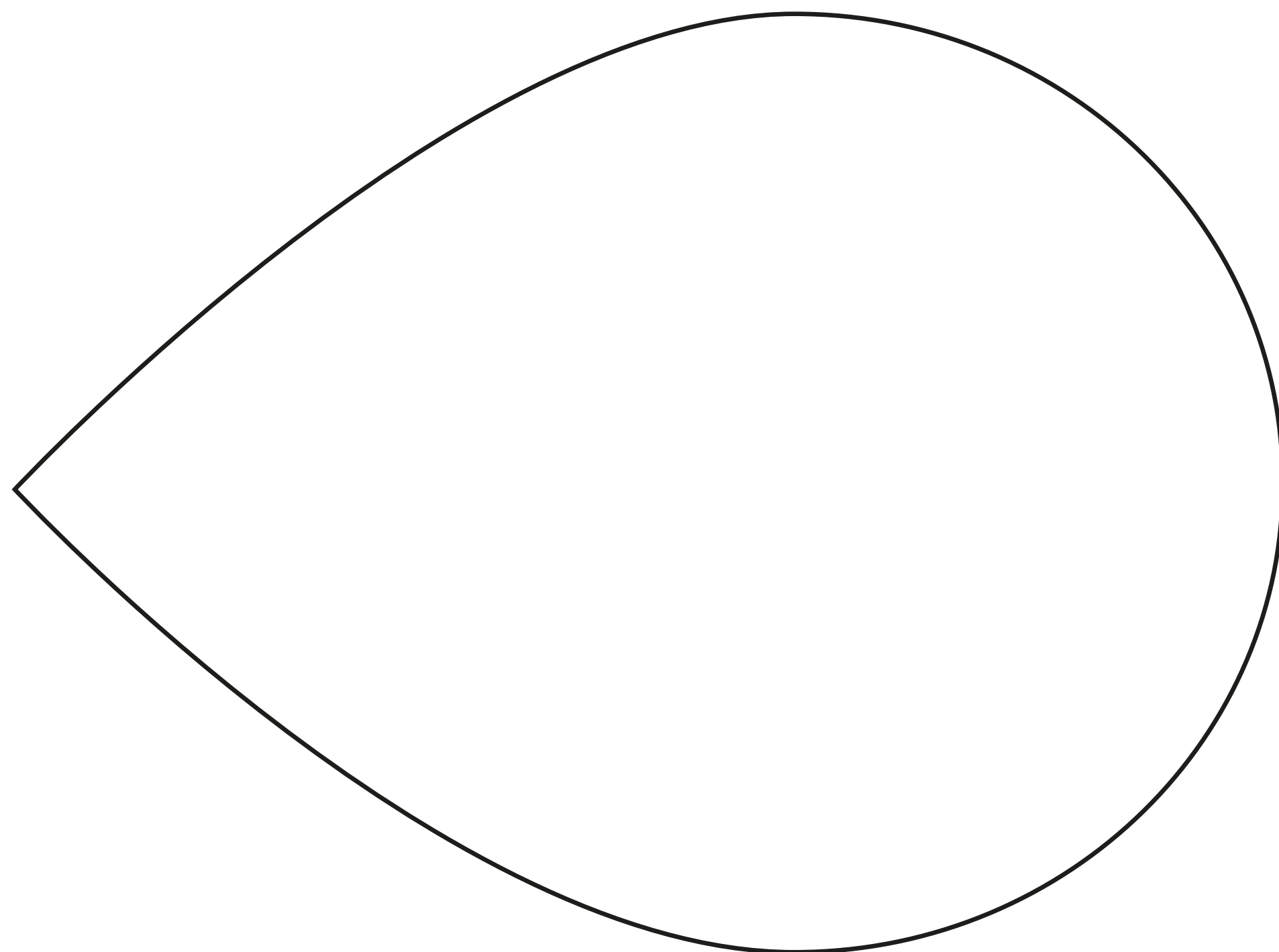

research project:

**Jugstrusions**







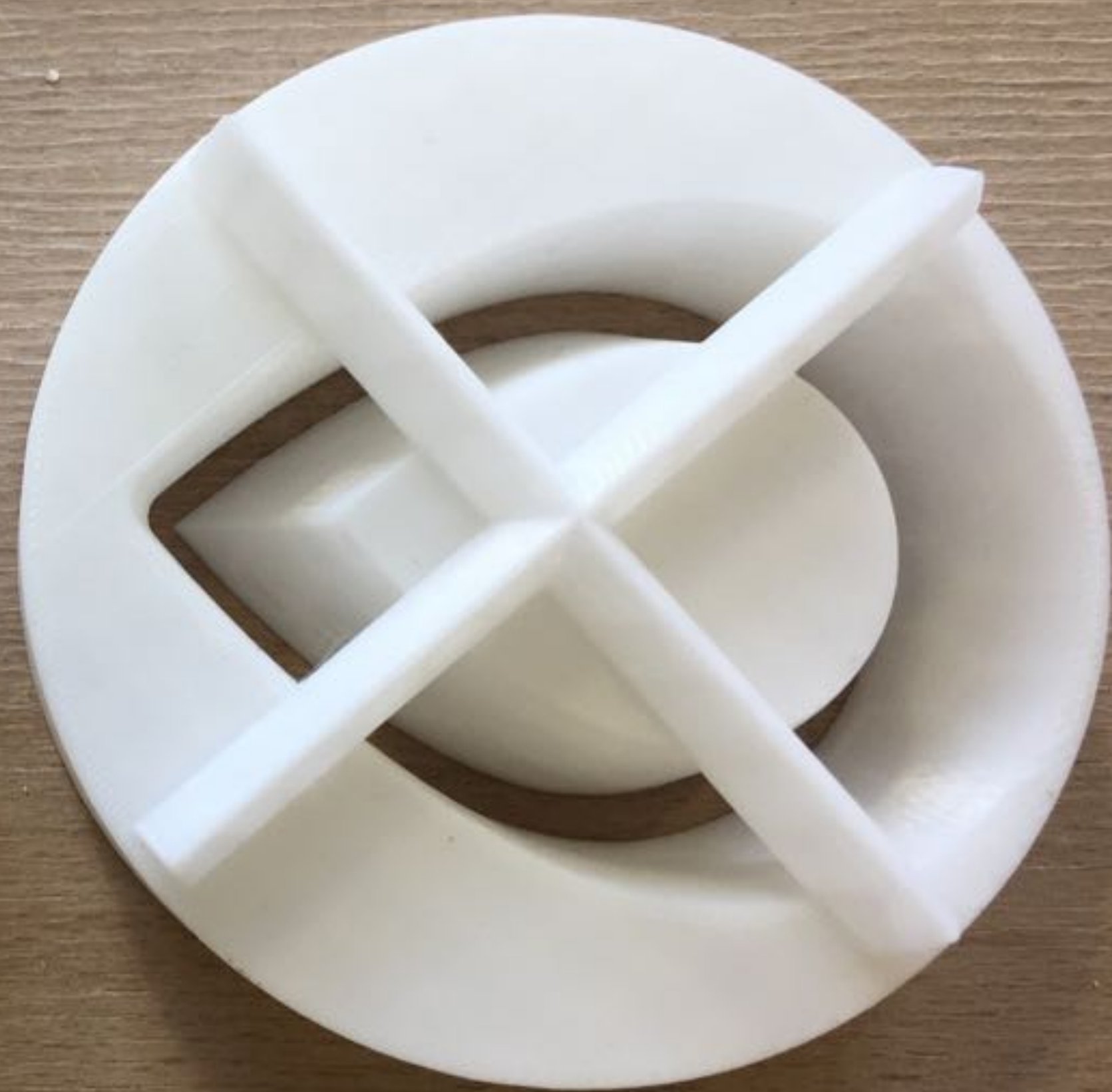

Command



- Persistent
- One shot
- End
- Near
- Point
- Midpoint
- Center
- Intersection
- Perpendicular
- Tangent
- Quadrant
- Knot
- Vertex
- On curve
- On surface
- On polysurface
- On mesh

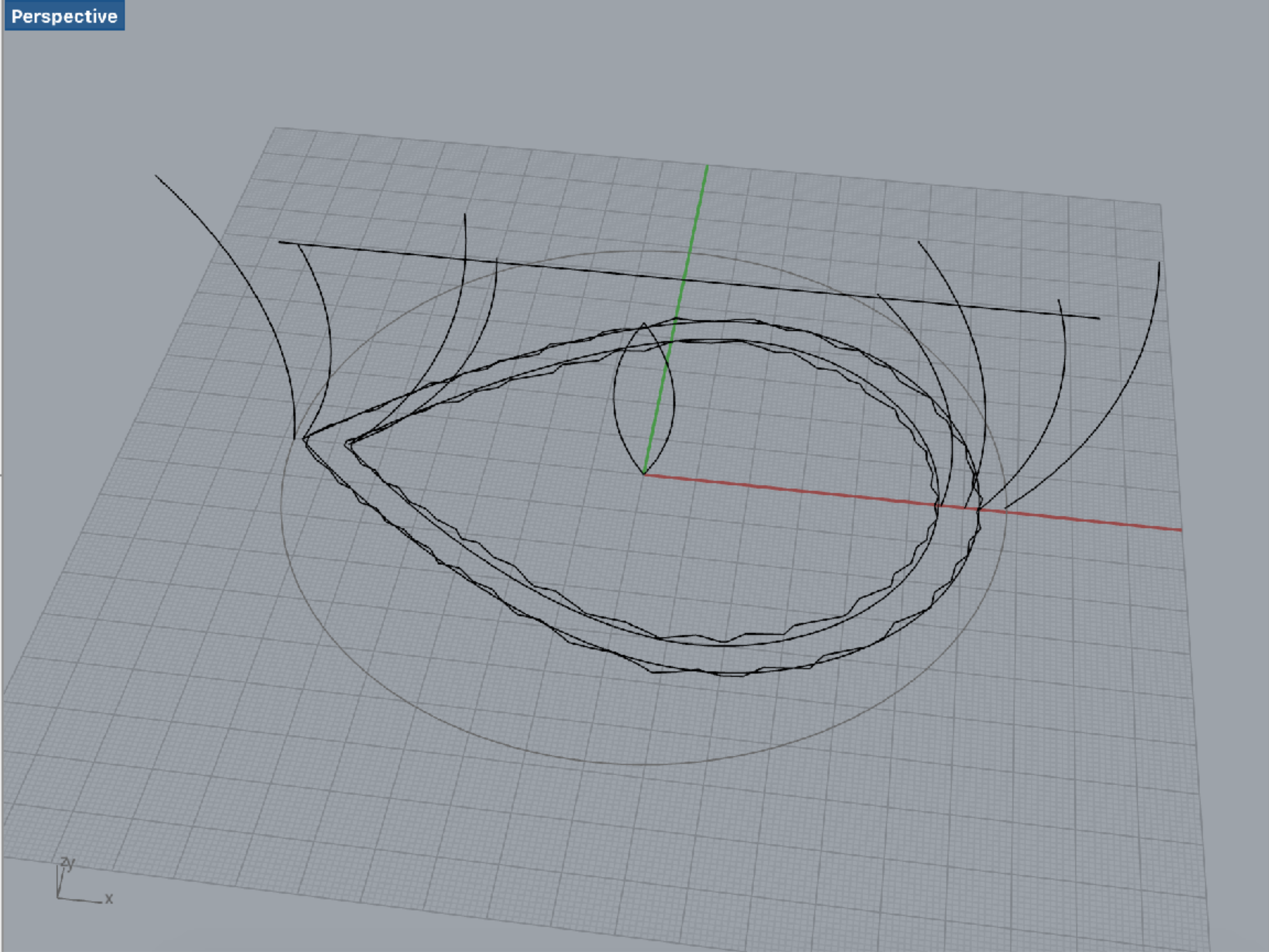

Name	Color	Linetype	Pr
D...	Light Blue	Conti...	◆
In...	Light Blue	Conti...	◆
E...	Light Blue	Conti...	◆
L...	Light Blue	Conti...	◆
Pl...	Light Blue	Conti...	◆
m...	Light Blue	Conti...	◆
n...	Light Blue	Conti...	◆
n...	Light Blue	Conti...	◆
T...	Blue	Conti...	◆

Command: Pan

Units CPlane X: 69.301 Y: -31.087 Z: 0.000

SmartTrack Gumball History

Top Front Front

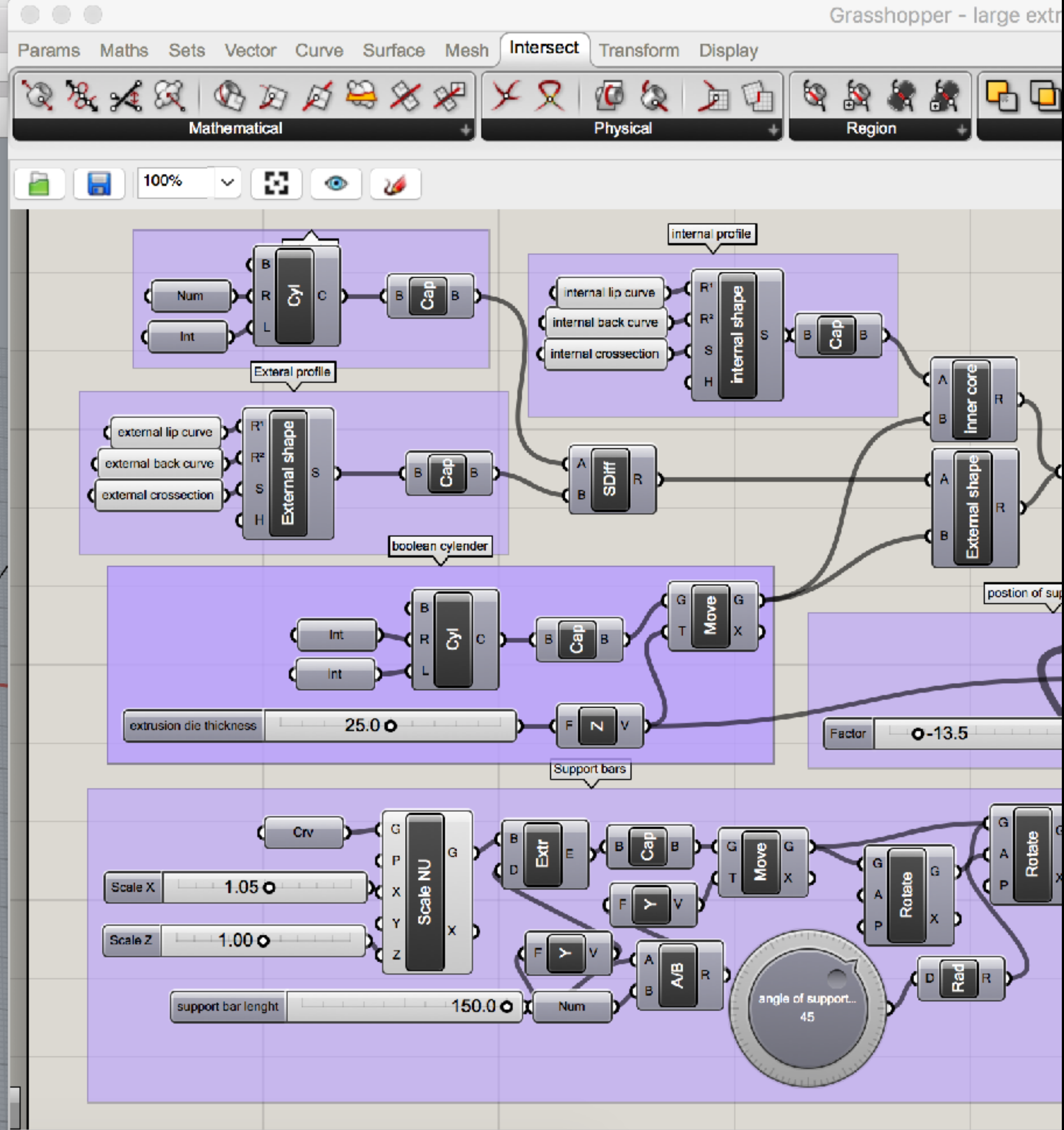
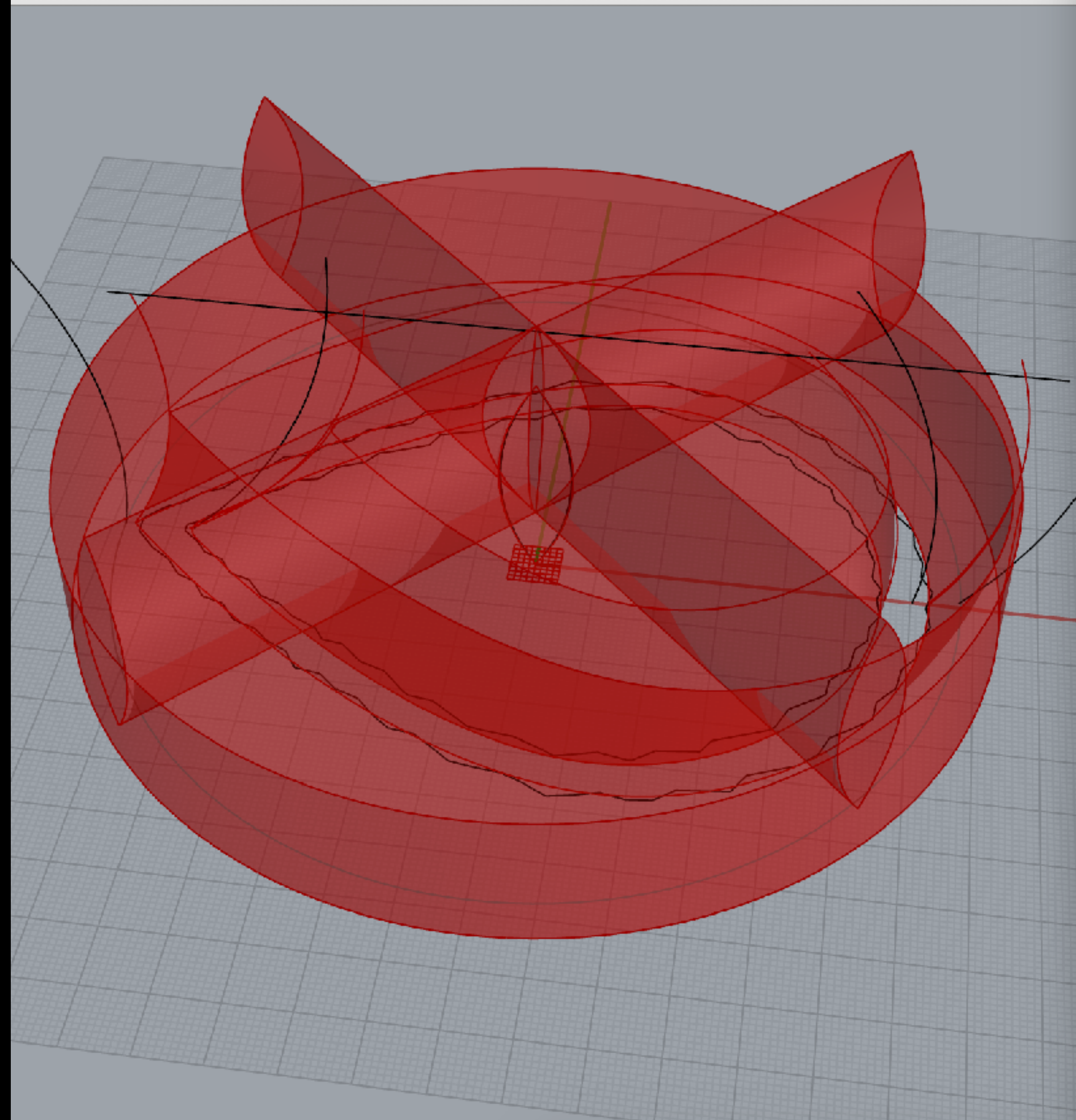







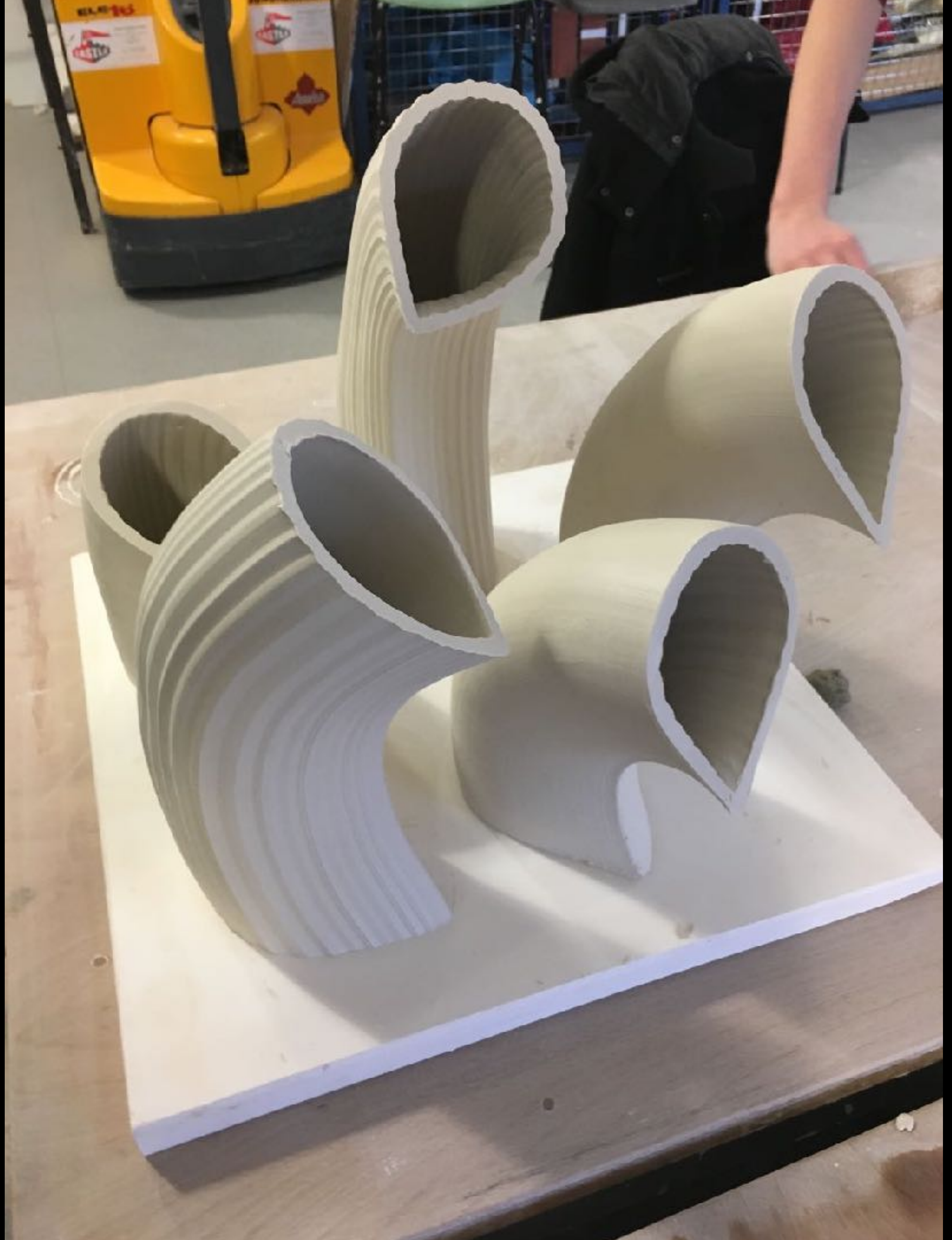







# Industrial Strategy

Building a Britain fit for the future







collaborating companies

ARUP

CENTRE FOR  
**WINDOW AND  
CLADDING**  
TECHNOLOGY



**SIBELCO**



**Wienerberger**

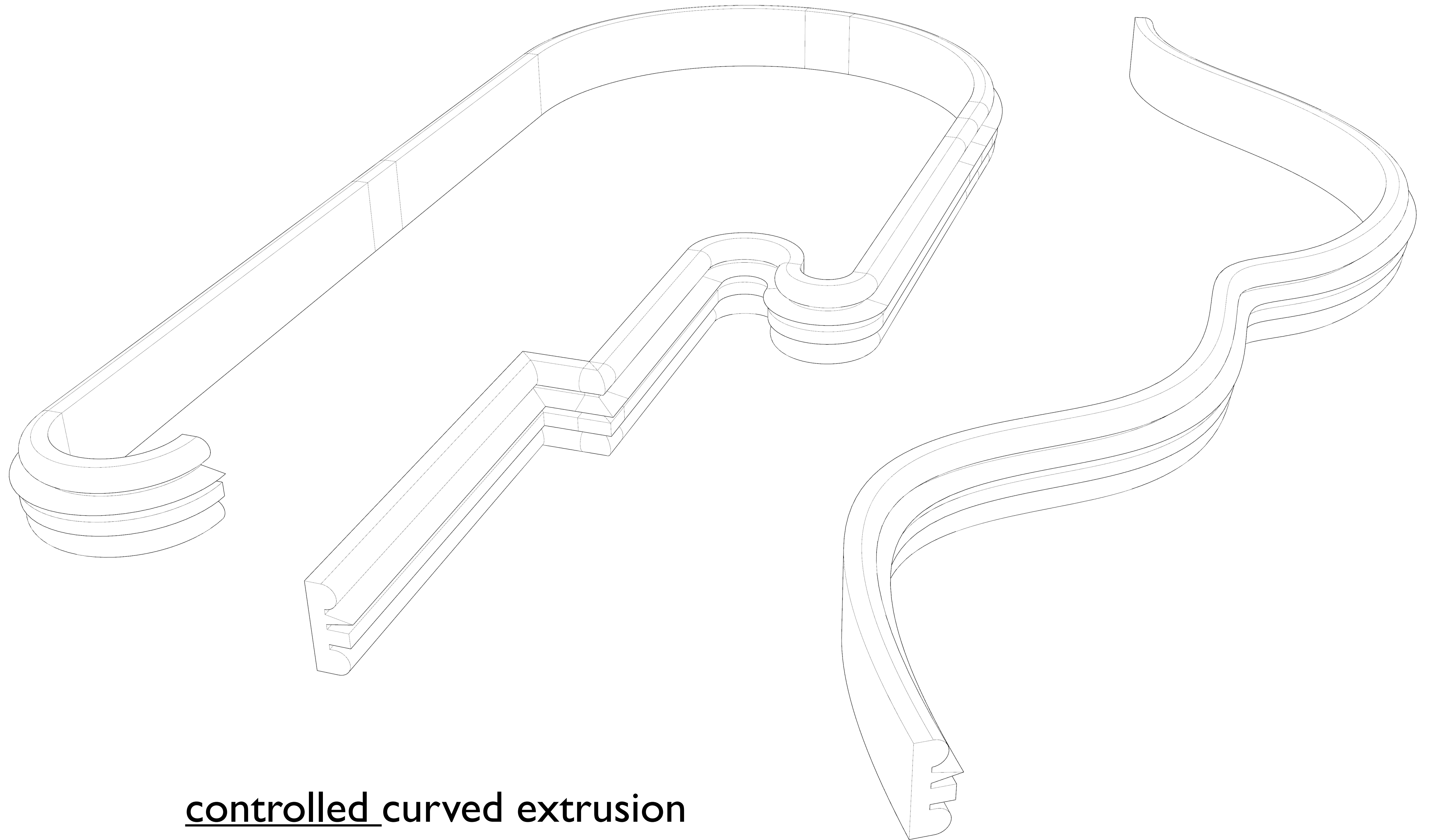

controlled curved extrusion













Tavs Jorgensen

[tavs.jorgensen@uwe.ac.uk](mailto:tavs.jorgensen@uwe.ac.uk)